

Series CSDXE absolute 4...20mA heavy duty shaft encoder up to 12mm



D E K 1 - X X X X - 0 X X X

Shaft Size | | | | Resolution
K1 = 12 X 25 mm | | | | 090 = 90 degrees

Output Type | | | | 180 = 180 degrees
06 = 2 wire | | | | 360 = 360 degrees
34 = 3 wire | | | | degrees per ramp (turn)

Connection | Exit
3 = 10 m cable | A = Axial
5 = 20 m cable | R = Radial



Zone 1, Class 1 Div 1

Technical Data

Operating temp: - 20 ...+ 60 degrees C
 - 4 ...+ 140 degrees F
 On request: -20 ... + 100 degrees C
 Current consumption: 80 mA (max.)
 Power supply: 24V
 Weight: 6 Kg
 Housing: Stainless Steel
 Shaft: Stainless Steel
 Bearings: 2 x 6001 ZZ
 Torque: 0.4 oz/in (3 N-cm)
 Humidity: Up to 98% permissible
 Speed: 3000 RPM max.
 Shaft load: Radial / Axial 10 N

Connection Options

2 wire version
 + Loop Red
 - Loop Black

3 wire version
 PS GND Back
 PS +24V Red
 Output 4...20mA White

Output

Count will increment in CW direction.

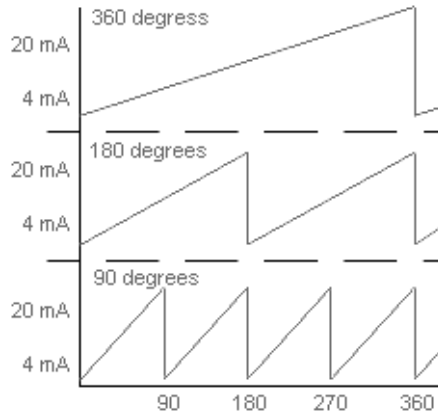

*4...20mA span based on 250 ohm load

Certifications

Does not require a barrier for use in hazardous areas, it is **Flameproof**, making the barrier redundant.

IP 66/X7

Ex d IIC

ATEX

IECEX

Mounting Instructions

To mount encoder on machine: Option 1 is to mount with three screws, option 2 is to use synchroflange mounting brackets. Hook up the encoder with the connections as described. Make sure power supply meets specifications. Attach encoder to mounting bracket as shown. Attach shaft using a flexible coupling.

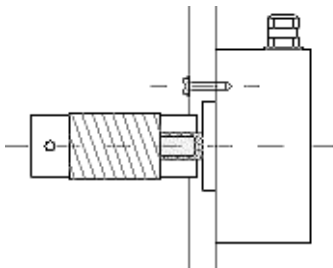

Dimensions

