

**Serie HP-HPH
HPC
Series HP-HPH
HPC**

**Potentiometer
für industrielle Anwendungen.
Ausgänge Kohm / 0-10Volt / 4-20mA**

**Potentiometers
for industrial use. Outputs Kohm / 0-10Volt / 4-20mA**

Mechanische Daten / Mechanics Data

Haube / Cover:	ABS (HP)
Haube / Cover:	Aluminium / Aluminium (HPH -HPC)
Flansch / Body:	Aluminium / Aluminium
Welle / Shaft:	Edelstahl / Stainless steel
Kugellager / Bearings:	doppelt gelagert / 2 ballraces
Gewicht / Weight:	150 g.HP – 300 g. (HPH- HPC)
IP Schutzarten / IP Protection:	IP54
Drehmoment / Torque:	5Ncm
Trägheitsmoment / Inertia:	100gcm ²
Wellenbelastung / Shaft Loading:	Axial 100N - Radial 100N



Elektronische Daten / Electronics Data

Toleranz / Tolerance:	+/- 5% vom Normalwert / of the nominal value
Linearität / Linearity:	+/- 0.25%
Rotation / Spin:	(n° giri x 360°) + 10°
Power / Power:	10K / 10giri 2 Watt 10K / 5giri 1.5 Watt 5K / 3giri 1 Watt
Betriebstemperatur / Oper. Temp:	-5/+70°C

Serie HP

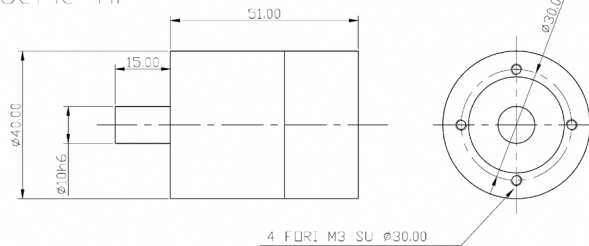

Serie HPC

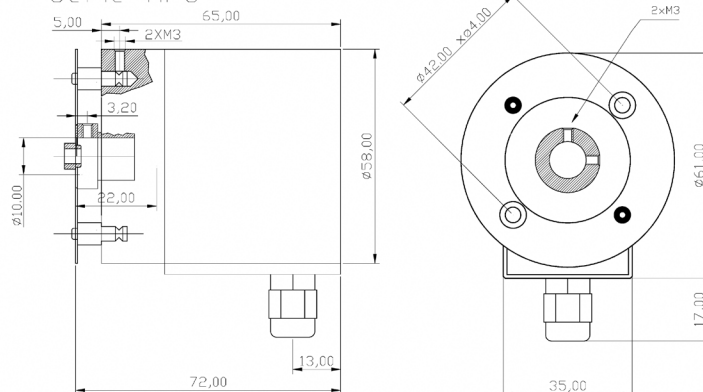

Alle Bilder sind Beispielbilder und können nicht als verbindlich eingestuft werden
All images are indicative and can not be considered binding the purpose of supplying

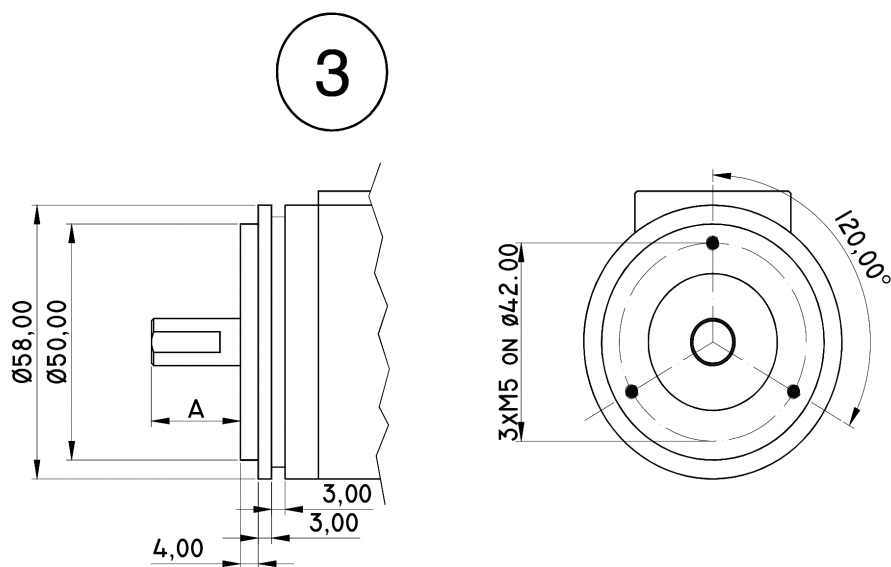
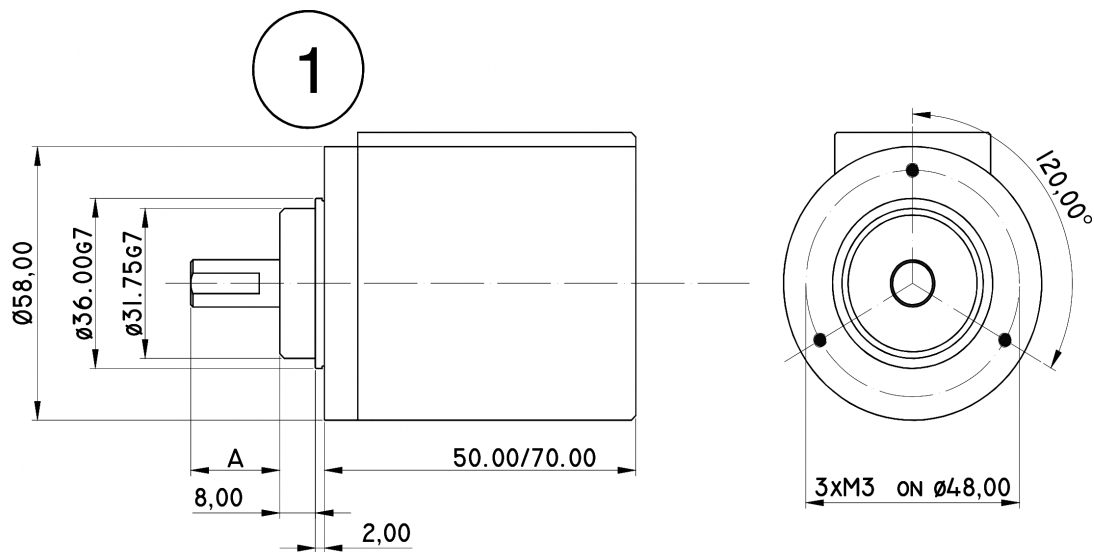

Bestellbezeichnung / Ordering Code

*	*	*	*	*	*	/	*
Serie Series	Welle Shaft	Flansche Flanges	Ausgangs- schaltungen Output	Anschlüsse Connections	Position Positions		Wert / Umdrehung Value / Turns
HP	1 = ø 10mm	1 = Flange 1					Kohm (All models) 10/10 = 10K/10 turns 10/5 = 10K/ 5 turns 5/3 = 5K/ 3 turns 10/1 = 10K/ 1 turns Only for HPH 10/20 = 10K/20 turns 0-10 Volt / 4-20mA (All models) 360 = 1 turns 1800 = 5 turns 3600 = 10 turns 7200 = 20 turns (only for HPH)
HPC	1 = ø 10mm	1 = Flange 1	1 = Kohm V = 0-10 Volt A = 4-20mA	1 = Kabel Cable	A = Axial R = Radial		
HPH	1 = ø 10mm 3 = ø 6mm	1 = Flange 1 3 = Flange 3					

Anschlüsse / Connections

	1	2	3	
Potentiometer Kabel 3-polig Potentiometer Cable 3 poles	Weiß White	Braun Brown	Grün Green	
0-10 Volt / 4-20mA Kabel 3- polig 0-10 Volt / 4-20mA Cable 3 poles	GND	Vin	Vout 0-10V Iout 4-20mA	