

Series 3000 heavy duty 4...20mA tachometer up to 12mm



3 X K 1 - 0 5 X X - X X X X

Protection
D = IP66 S. St.

Connection
1 = 2m cable
2 = 5m cable

Exit

A = Axial
R = Radial

Speed (RPM)

4mA = 0 RPM
20mA = Max RPM
Rated RPM: Min 300, Max 3000



Technical Data

Operating temp: - 20 ...+ 60 degrees C
- 4 ...+ 140 degrees F

Weight: 43 oz (1.2 kg)

Protection: IP 65 (IP54 available)

Housing: Stainless Steel

Shaft: Stainless Steel

Bearings: Ball Races 2 x 6001 ZZ

Torque: 0.7 oz/in (5 N-cm)

Humidity: Up to 98% permissible

Max Speed: 3000 RPM max.

Shaft load: Supports its own weight

Precision:

0 rpm = +/- 0.05mA

1 rpm to max rpm = +/- 0.2 mA

Connection Options

+ Loop

- Loop

Cable

Red

Black

Output

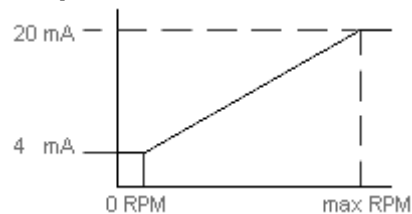

*4...20mA span based on 250 ohm load

Certifications

Best suited to work with the following isolators: [MTL5541](#)

IP 66

ATEX

Mounting Instructions

Hook up the encoder with the connections as described. Make sure power supply meets specifications. Attach encoder to mounting bracket as shown. Attach shaft using a flexible coupling.

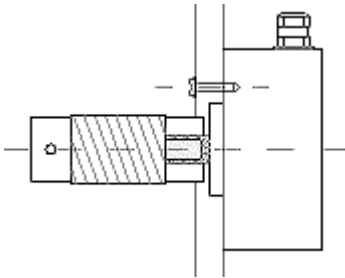

Dimensions IP66

