

Series CSMXE stainless steel parallel absolute shaft encoder

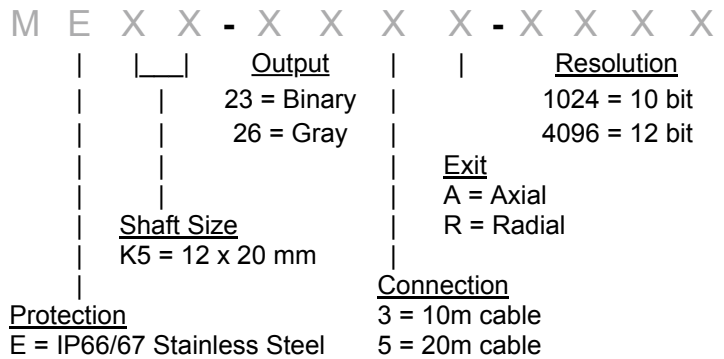

IECEX



Class I, Zone 1; Zone 21; Class II, Div 2

Technical Data

| | |
|-------------------------|--|
| Operating temp: | - 20 ...+ 60 degrees C - 4 ...+ 140 degrees F |
| Power supply: | 11 - 24V |
| Current consumption: | 100 mA (max.) |
| Line driver output max: | 50 mA per channel |
| Weight: | 2.5Kg |
| Protection: | IP 66 / 67 |
| Housing: | S. Steel |
| Shaft: | S. Steel |
| Bearings: | 2 x 6001 RSH |
| Torque: | 0.4 oz/in (3 N-cm) |
| Shaft Seal: | Nitrile Double Lip |
| Humidity: | Up to 98% permissible |
| Speed: | 3000 RPM max. |
| Shock: | 10g (6msec) |
| Vibration: | 5g (500 Hz) |
| Shaft load: | Radial max 10 lbs |

Connection Options

| Bin / Gray | cable with colours |
|----------------|--------------------|
| PS GND | Black |
| PS 12 ... 24 V | Red |
| 2-0 | White |
| 2-1 | Blue |
| 2-2 | Yellow |
| 2-3 | Green |
| 2-4 | Violet |
| 2-5 | Brown |
| 2-6 | Pink |
| 2-7 | White/Red |
| 2-8 | Grey |
| 2-9 | White/Green |
| 2-10 | White/Yellow |
| 2-11 | White/Blue |
| For cw | White/Black NC |
| For ccw | White/Black to GND |

Output

Count will increment in cw direction

Binary Code Output

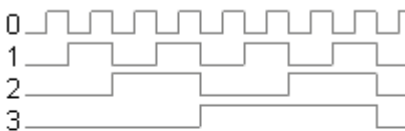

Gray Code Output

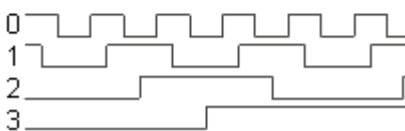

Certifications

Flameproof, does not require barrier for use in hazardous areas, and we use a barrier gland for added safety

IP 66/X7

ATEX [\[Certificate\]](#)

IECEX [\[Certificate\]](#)

CSA [\[Certificate\]](#)

GOST-CU [\[Certificate\]](#)

Mounting Instructions

To mount encoder on machine: Option 1 is to mount with 3 screws or, option 2 is to mount using synchroflange mounting brackets. Hook up the encoder with the connections as described. Make sure power supply meets specifications. Attach encoder to mounting bracket as shown. Attach shaft using a flexible coupling.

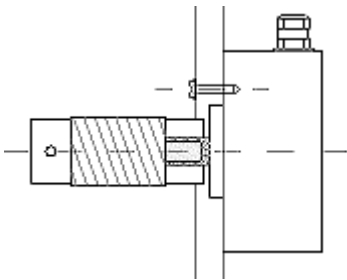

Dimensions

